

AREA PLAN

NEW SQUARES

PENRITH, Cumbria, CA11

Unit L1 - Ground Floor

Net Internal Area

	NIA - Retail	173.5 sq m	1868 sq ft
---	---------------------	-------------------	-------------------

TOTAL NIA: 173.5 sq m 1868 sq ft

The following has been EXCLUDED from the TOTAL NIA:

Landlord Plant	0.7 sq m	8 sq ft
Staff Toilets	6.0 sq m	65 sq ft

Gross Internal Area

	GIA	181.6 sq m	1955 sq ft
---	------------	-------------------	-------------------

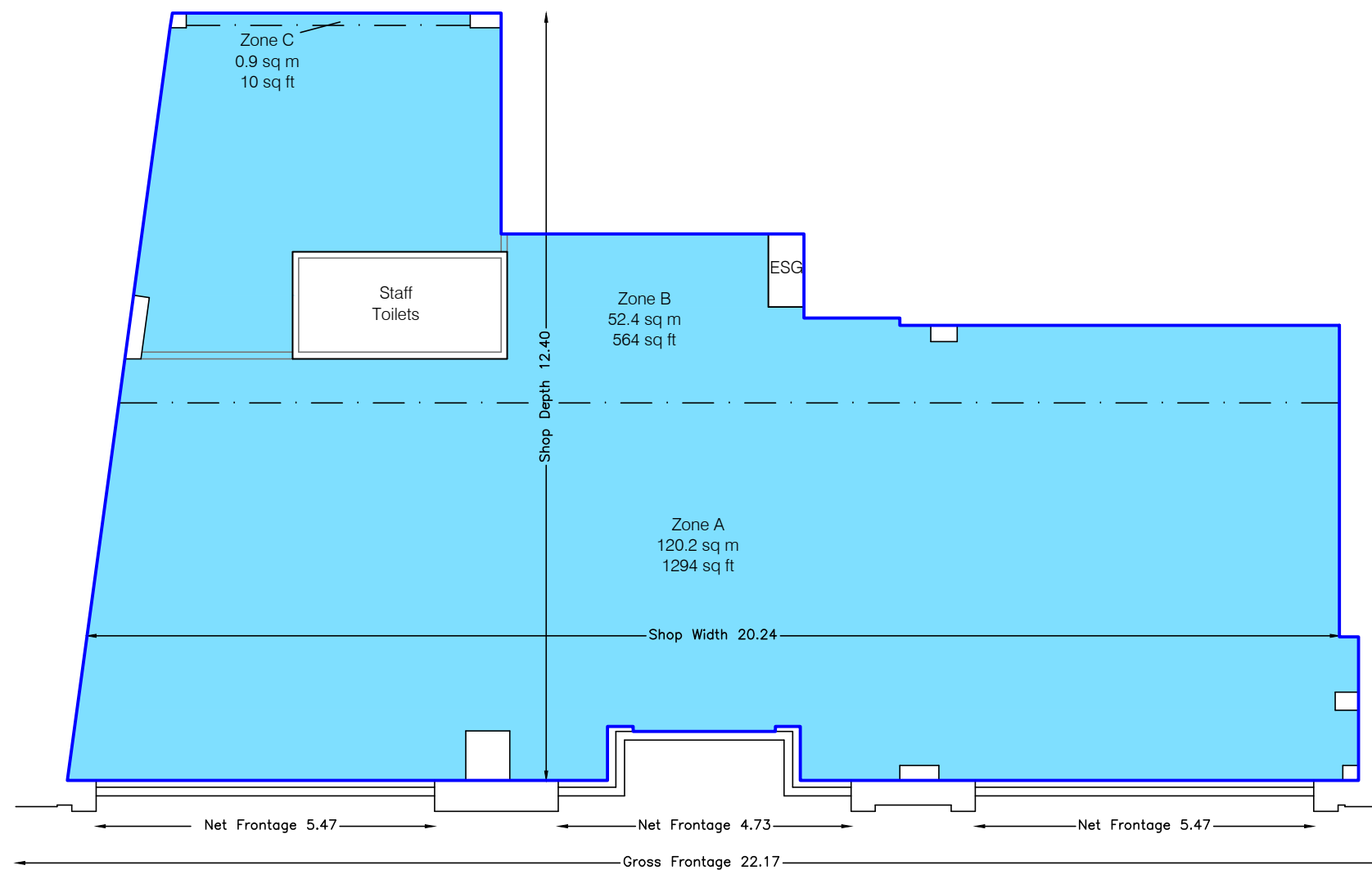

BREWERY LANE

Notes:

- (X.XX) - Floor to Ceiling Height (Metres)
- A dashed line denotes assumed - inaccessible due to fit out.
- This drawing indicates the extent of the areas quoted, produced to an accuracy commensurate with standard presentation scales. It is held in a scaled digital CAD format.

Dwg No. LF3351-19-UL1-AG

Issue A June 2021

Scaled for presentation - 1:100 @ A3

Lane &
Frankham

